

Stuffing Box / Bearings

Combines a rudderpost bearing with an above-the-waterline stuffing box for rudderpost sizes ranging from 1" (2.5 cm) diameter to 4½" (11.4 cm). We recommend fiberglassing the stuffing box/bearing to the top of the tubing when the rudderpost is in place. This can be done easily using alternating layers of fiberglass mat and cloth. This makes the post a structural bearing and will help carry rudder loads with minimal friction. Custom sizes are available on request, but allow additional time.

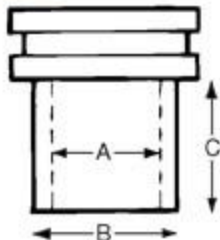

Stuffing Box #697

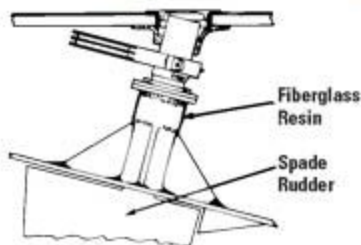

STUFFING BOX ORDERING GUIDE									
For Rudderpost Diameter*	Order #	A**		B		C		Weight	
		in	mm	in	mm	in	mm	lb	Kg
1"	697-1.0	1	25	2	51	1.25	32	2.5	1.1
1¼"	697-1.125	1.125	29	2	51	1.25	32	2.5	1.1
1½"	697-1.25	1.25	32	2	51	1.25	32	2.5	1.1
1¾"	697-1.375	1.375	35	2	51	1.25	32	2.5	1.1
1½"	697-1.5	1.5	38	2	51	1.25	32	2.5	1.1
1¾"	697-1.625	1.625	41	2	51	1.25	32	3	1.4
1.660"	697-1.660	1.660	42	2	51	1.25	32	3	1.4
1¾"	697-1.75	1.75	44	2.44	62	1.25	32	3	1.4
1¾"	697-1.875	1.875	48	2.44	62	1.25	32	3	1.4
1.9"	697-1.9	1.9	48	2.44	62	1.25	32	3	1.4
2"	697-2.0	2.0	51	2.44	62	1.25	32	3.5	1.6
2¼"	697-2.25	2.25	57	3	76	1.25	32	3.5	1.6
2½"	697-2.375	2.375	60	3	76	1.25	32	3.5	1.6
2½"	697-2.5	2.5	64	3	76	1.25	32	4	1.8
2.860"	697-2.860	2.860	73	3.5	89	1.25	32	4	1.8
2¾"	697-2.875	2.875	73	3.5	89	1.25	32	4	1.8
3"	697-3.0	3.0	76	3.5	89	1.75	44	4.5	2
3½"	697-3.5	3.5	89	4	101	1.75	44	4.5	2
4"	697-4.0	4.0	101	4	101	1.75	44	6	2.7
4½"	697-4.5	4.5	114	5.125	130	1.75	44	6	2.7

* Metric and Custom sizes available on request.

** 'A' Dimension is actually bored +.003" over rudderpost size for proper clearance.