

*** BOTTOM DIMENSIONS 1" SMALLER ON ALL SIDES ***

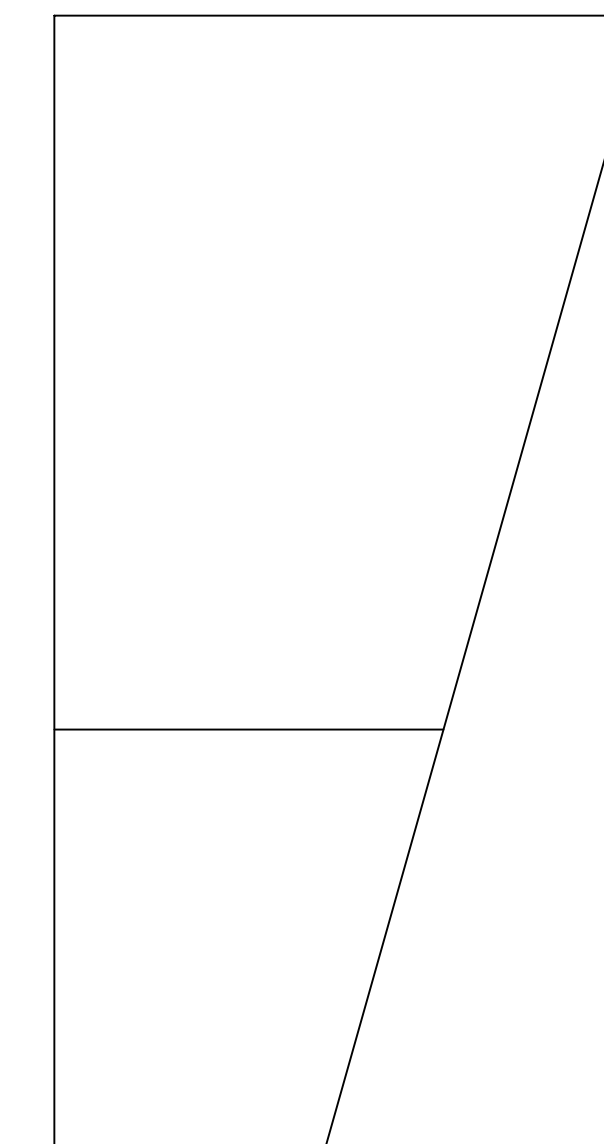

1 1/2" OD PIPE
2 1/2" CLEAR LENGTH
BARB LENGTH
HIGH AS POSSIBLE

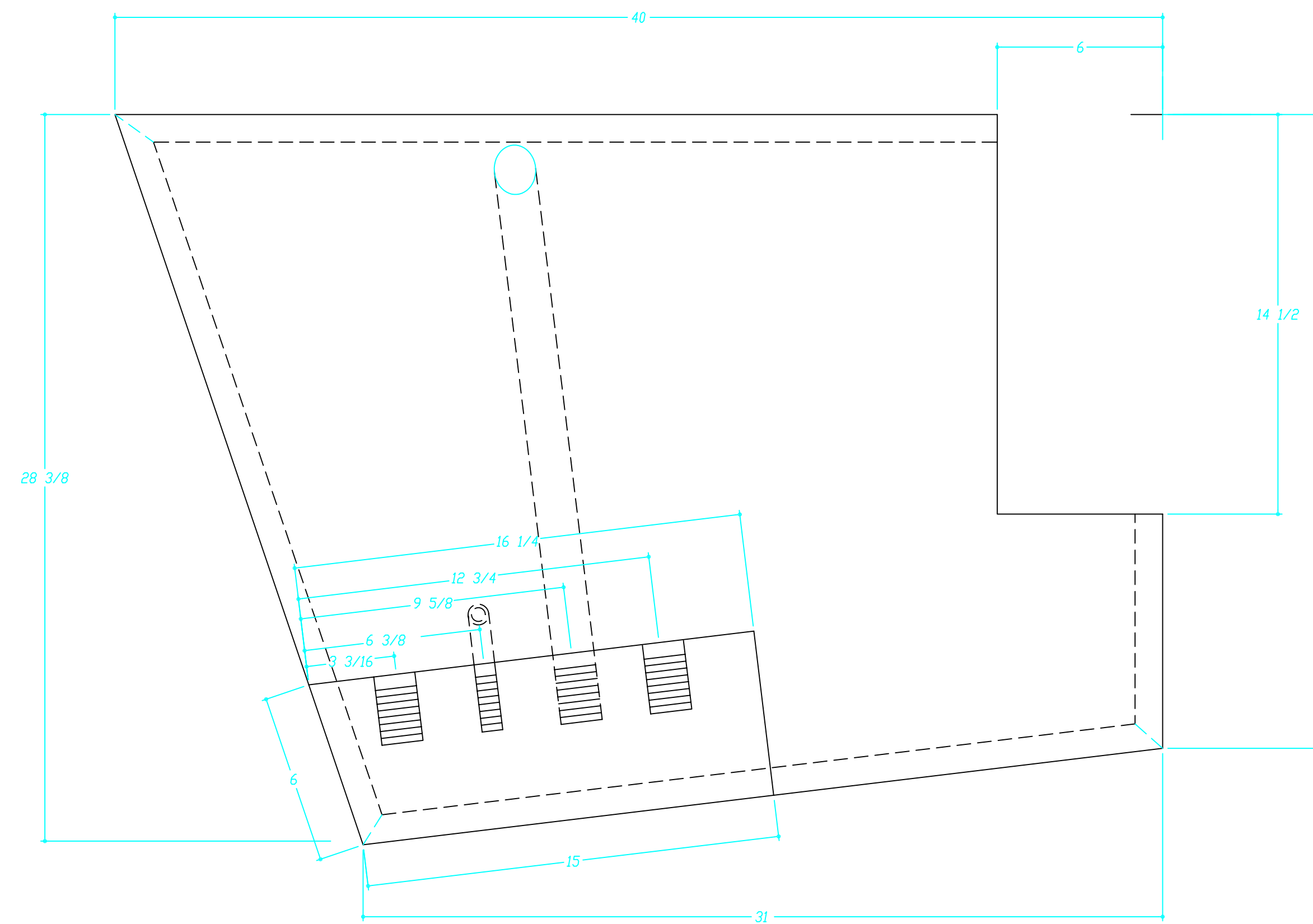
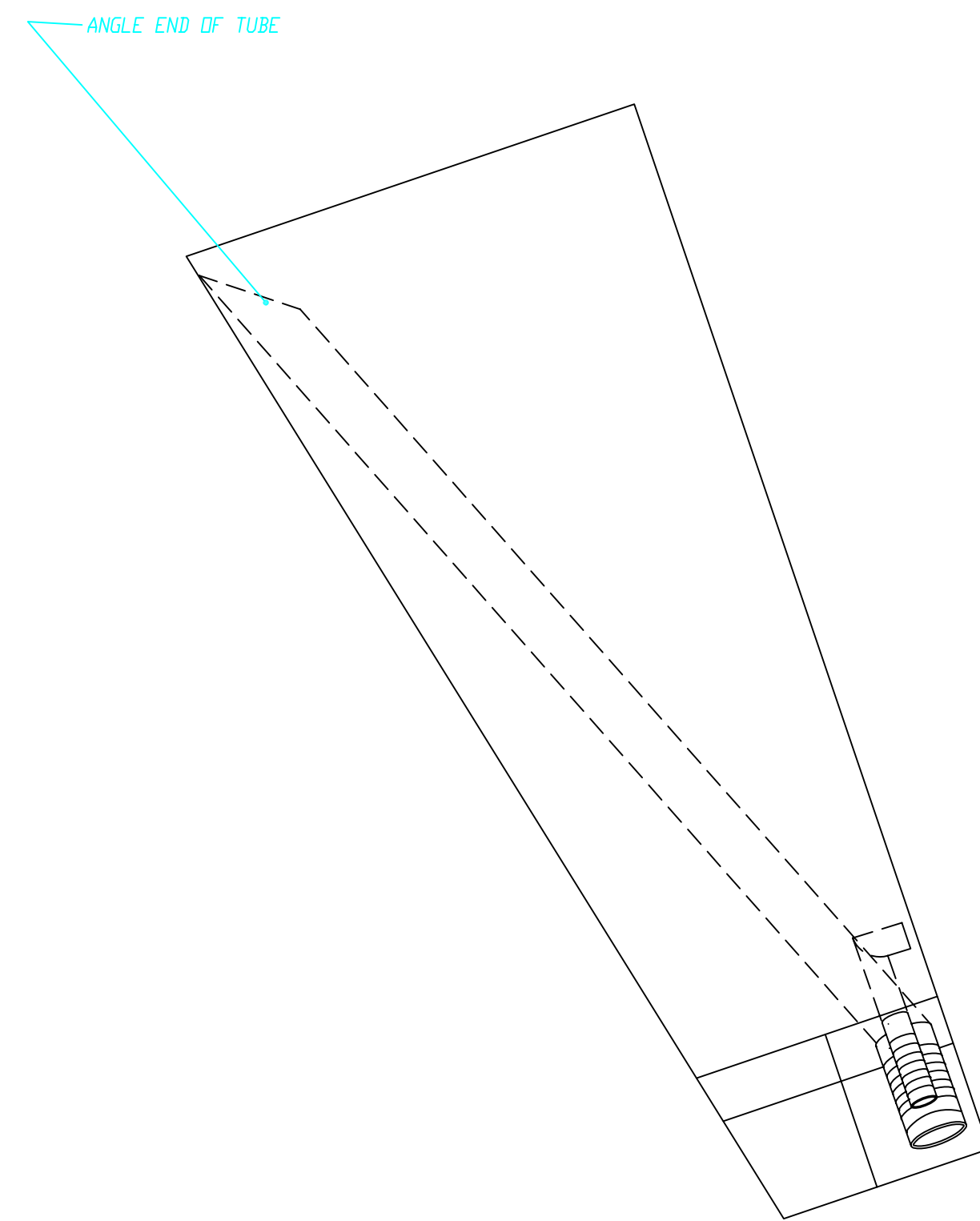
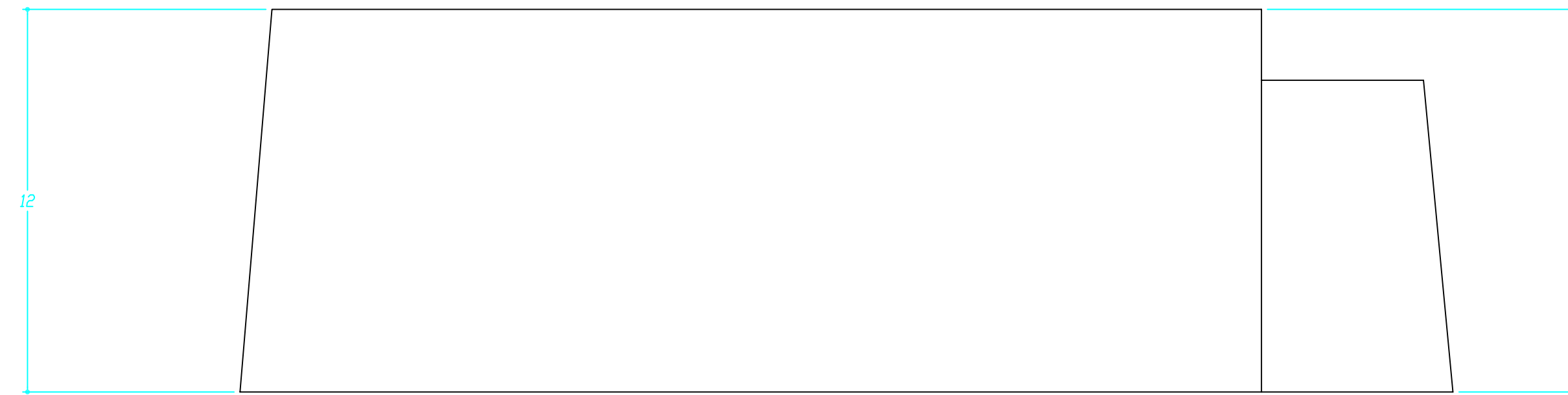
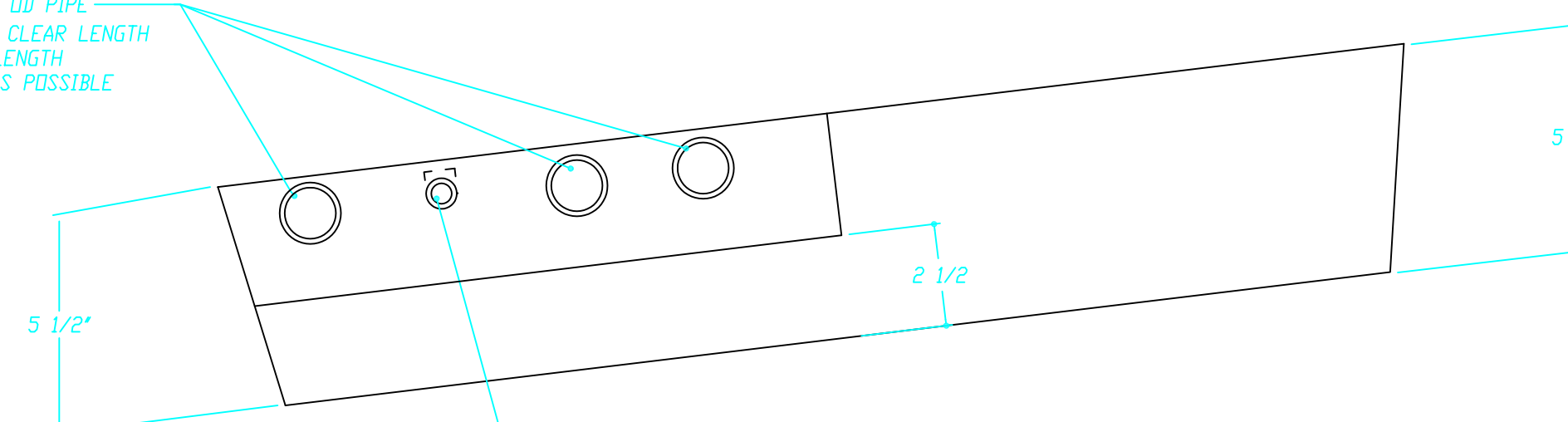

3/4" OD PIPE
2 1/2" CLEAR LENGTH
BARB LENGTH
TURN UP INSIDE TANK
TO 1/4" OFF TOP OF TANK

- NOTES:**
1. MATERIAL: 6061-T6 ALUMINUM
 2. FINISH: BRIGHT POLISH ALL WELDS
 3. ALL WELDS: STRUCTURAL
 4. ALL DIMENSIONS: MAX TO FIT IN SPACE
 5. MAKE BAFFLES TO U.S.C.G. REGS
 6. ALL FITTINGS 2 1/2' LONG

DATE: 11-6-90		PROPRIETARY INFORMATION: This document discloses information for which HUNTER MARINE CORP. has proprietary rights.	
DRAWN BY: LYNNE		TOLERANCES UNLESS OTHERWISE SPECIFIED:	
CHECKED BY: LYNNE		FRACTIONAL ± N/A	
SYMBOLS: A		2 PLACE DECIMAL ± N/A	
		3 PLACE DECIMAL ± N/A	
		4 PLACE DECIMAL ± N/A	
		ANGULAR ± N/A	
		BREAK ALL SHARP EDGES, DEBURR FINISH N/A	
DRAWING TITLE: H43 STBD AFT METAL WATER TANK		PAPER SIZE: D	SCALE: 3"=1'
DRAWN BY: LYNNE		DATE: 11-13-90	SCALE: 3"=1'
PLOT SCALE: 25=1		HUNTER PART NO: PL-1206	DRAWING NO: H43-D-1916